

MODEL CK100 Conversion Kit

ASSEMBLY AND INSTRUCTION MANUAL

Parts List

2 - Adjustable Tubes
2 - Mounting Blocks

Hardware Pack

14- #10 x 1-1/4" screw

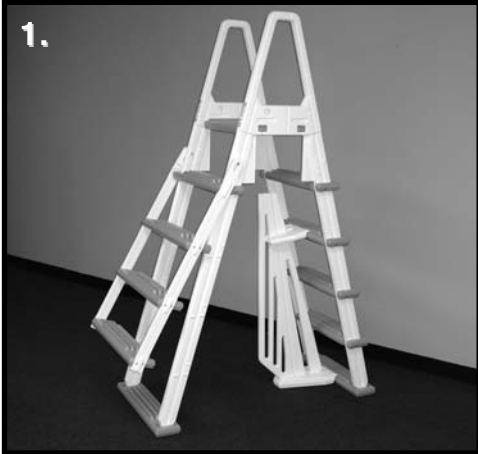

7000B Ladder

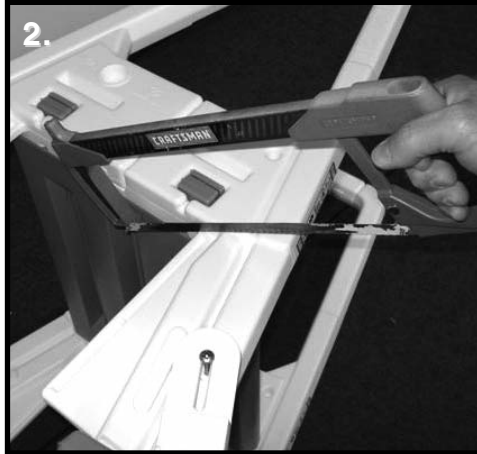

Lay ladder on side, using a hacksaw cut both outside ladder rails under deck platform.

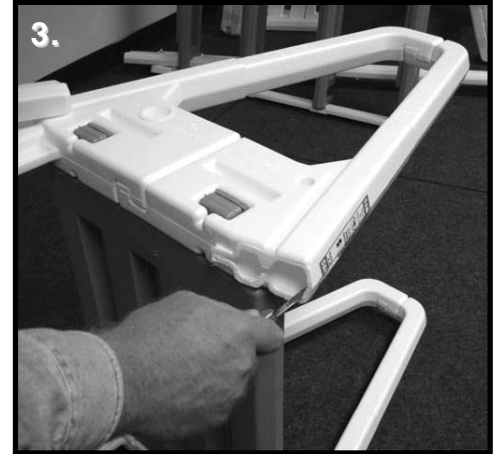

Trim inside of handrails.

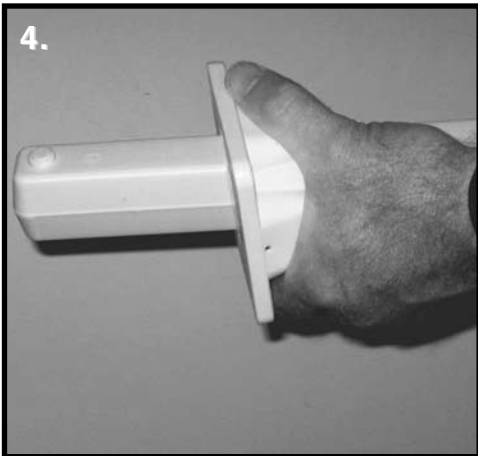

Slide the mounting block over the adjustable tube until seated on the tabs.

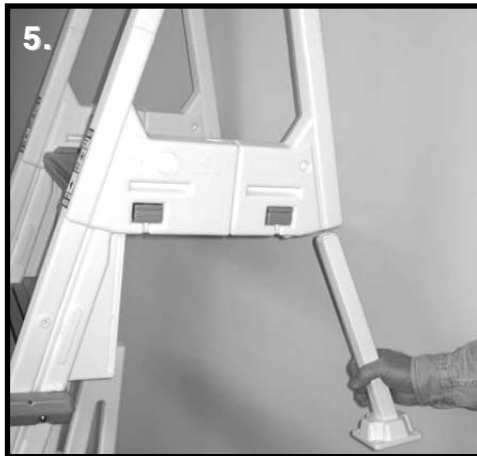

Slide adjustable tube into ladder rails.



Complete 6000B In Pool Ladder

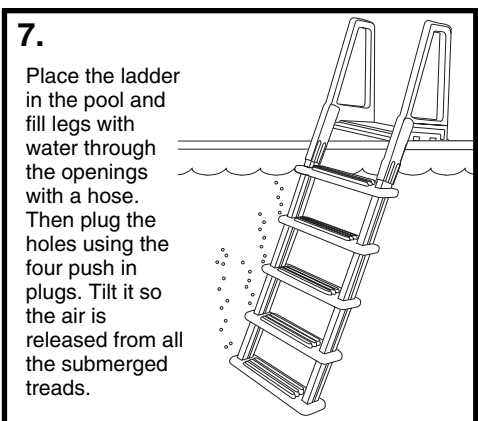

7.
Place the ladder in the pool and fill legs with water through the openings with a hose. Then plug the holes using the four push in plugs. Tilt it so the air is released from all the submerged treads.

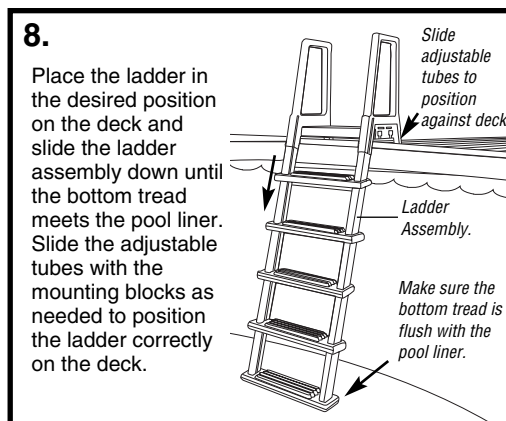

8.
Place the ladder in the desired position on the deck and slide the ladder assembly down until the bottom tread meets the pool liner. Slide the adjustable tubes with the mounting blocks as needed to position the ladder correctly on the deck.

Slide adjustable tubes to position against deck.

Ladder Assembly.

Make sure the bottom tread is flush with the pool liner.



MADE IN THE U.S.A. by:
CONFER
plastics inc.

97 Witmer Road
North Tonawanda, NY 14120-2421
Toll Free U.S. 866-396-2968
Tel: 716-283-1826 / FAX: 716-283-3249
www.conferladders.com