

SAVE THESE INSTRUCTIONS

DEALER/INSTALLER: GIVE TO HOMEOWNER

MODEL 635-52

ALL PLASTIC INPOOL LADDER **ASSEMBLY AND INSTRUCTION MANUAL**



- 635-52 Fits Decks 46"-56"
- Easy Assembly
- Adjustable Handrail Mounting System

Note: 10 Lbs of sand required (See Step 2)

***Model 635-52 is a straight up-and-down ladder and should be installed 3" to 6" from the pool wall.**



Made in U.S.A. by

CONFER
plastics inc.

CONFER LADDERS ARE DESIGNED FOR EASE OF ASSEMBLY AND ARE CONSTRUCTED OF MAINTENANCE-FREE, NON-CORROSIVE RESINS AND MATERIALS.

Note: WARRANTY ON PAGE 4. PLEASE SAVE THIS BOOKLET AND YOUR WARRANTY.

CONFER PLASTICS, INC.

Model #635-52

ASSEMBLY INSTRUCTIONS - PLEASE READ BEFORE ATTEMPTING ASSEMBLY

Parts List

- 2 - Handrails
- 1 - Ladder Section

Hardware Pack

- 14 - #10 x 1-1/4" Screws
- 1 - Threaded Cap
- 2 - Mounting Blocks
- 2 - Adjustable Tubes

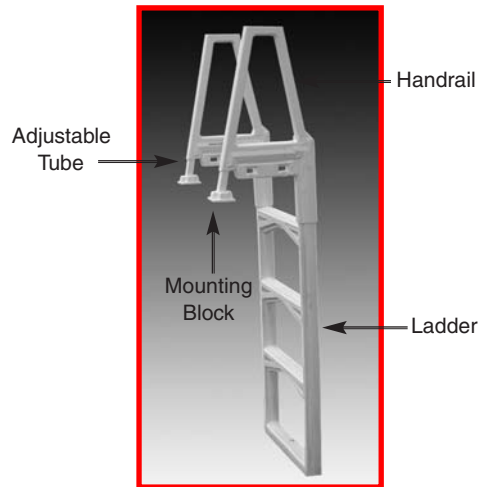

Tools Needed for Assembly

- * Sand - 10 lbs
- * Cordless Drill Motor
- * 1/8" Drill Bit
- * Phillips Screwdriver
- * Tape Measure
- * Liquid Soap or Lubricant

If missing parts call - Toll free U.S. - 866-396-2968 or www.conferladders.com

Step 1.

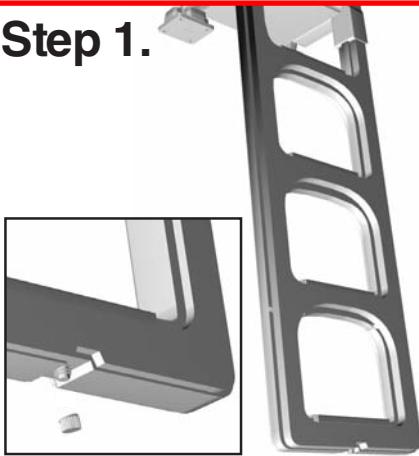

Install threaded cap over bottom drain hole.

Step 2.



Pour 5 lbs of sand into each leg. Fill remainder with water.

Step 3.



Slide the handrails onto the legs. **DO NOT** secure with screws at this stage.

Step 4.

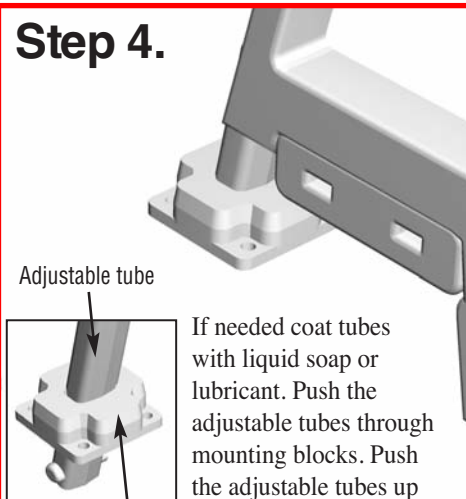

Adjustable tube

If needed coat tubes with liquid soap or lubricant. Push the adjustable tubes through mounting blocks. Push the adjustable tubes up into the handrails.

Mounting block

Step 5.

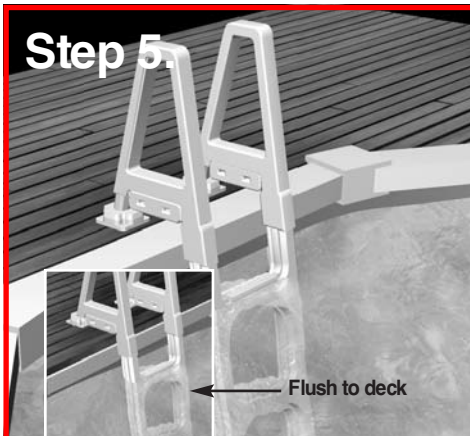

Place the ladder into the pool and position mounting blocks on deck. Slide the adjustable tubes up or down as needed until mounting blocks are sitting flush on the deck. Ladder **MUST** rest on pool bottom. If not, EB100 riser(s) are required. (See page 3 to order)

Step 6.

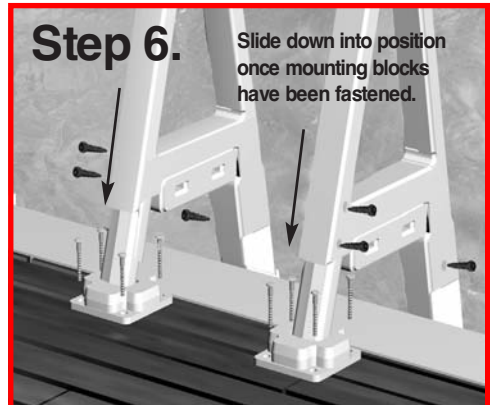

Slide down into position once mounting blocks have been fastened.

Drill four pilot holes (1/8") through holes in each block into wood surface. Fasten blocks to deck using the four #10 x 1-1/4" screws per mounting block. Drill three holes through each side of each handrail at the pre-marked locations. Fasten using three #10 x 1-1/4" screws.

For winterizing in cold climates remove ladder from the pool, and drain water from ladder.

IMPORTANT FOR YOUR SAFETY

- * Check the contents of the carton with the Parts list for this ladder.
- * If any parts are missing call Toll Free U.S. - 866-396-2968 or visit our web site at www.conferladders.com
- * **DO NOT** attempt to assemble or install the ladder if there are **ANY** shortages of parts or hardware.
- * For proper assembly and installation follow all instructions in the sequence shown.
- * Before using the product, after assembly and installation, go over the instructions and procedures again to make sure nothing has been overlooked.
- * Be sure and safe. The manufacturer **IS NOT** responsible for improper assembly, installation and use.

ADDITIONAL ACCESSORIES For #635-52 Ladder

SKIM-IT



SKIMS OFF DEBRIS

Cut cleaning time 75% with skimmer extension that guides debris directly into your skimmer. Fits most in-ground and above-ground pool skimmers. Corrosion-resistant plastic Skim-It installs in seconds without tools.

EB 100-3" RISER

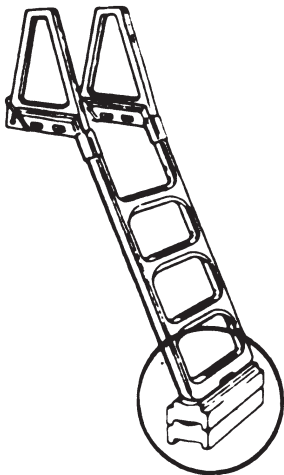

Used to raise ladder when deck is built higher than pool. Maximum 2 risers. Fill with sand and water, rest ladder on top. Straps included.

DK300 DECK KIT

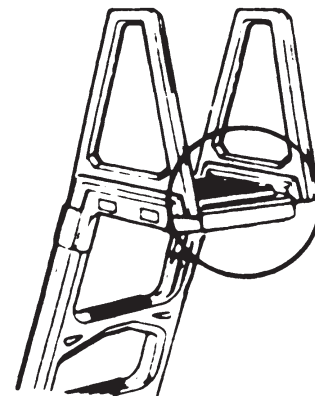

Platform provides extra "step" at top of ladder. Prevents swimmers from stepping on pool top.

NOTE: Check with your dealer for availability first
or order online at: www.conferladders.com

SAFETY RULES

- * One person on the ladder at a time
- * Ladder **MUST** be installed per manufacturer's instructions
- * **DANGER:** No Jumping or Diving from ladder
- * Face ladder when entering and leaving pool
- * To prevent entrapment or drowning —
DO NOT swim through, behind or around ladder
- * Ladder to be used as a swimming pool ladder only.
- * Weight limit - **250 lbs maximum**
- * **Warning:** Exceeding the maximum weight restriction may cause the ladder to fail.
- * Consult your local Building Department before installation of your pool and equipment.
- * **DANGER:** *Use a cordless drill for assembly and installation
Never use an electric drill in or around the pool.*

CONFER PLASTICS, INC. LIMITED, PRO-RATED WARRANTY

Confer Plastics, Inc. warrants their swimming pool ladders to be free from defects in workmanship for one year from date of purchase. After the first year the cost to replace a part is as follows:

MODEL #635-52

2nd Year - 20%

3rd Year - 40%

4th Year - 60%

5th Year - 80%

Plus shipping/handling

} of current parts
list price

DO NOT RETURN DEFECTIVE PART TO DEALER

The defective part should be returned, postpaid, to:

Confer Plastics, Inc.

97 Witmer Road

North Tonawanda, N.Y. 14120-2421

Enclose proof-of-purchase (receipts, etc.) showing date purchased, your name, address, and daytime phone number. You will be notified of cost to replace part.

This warranty gives you specific legal rights, and you may also have other rights which may vary from state to state.

MADE IN THE U.S.A. BY:



CONFER
plastics inc.

97 Witmer Road
North Tonawanda, NY 14120-2421
Toll Free U.S. 866-396-2968
Tel: 716-283-1826 / FAX: 716-283-3249
www.conferladders.com